

PRIVATE EVENTS AT



Private events are available exclusively at our Pinthouse Brewing location at 2201 E. Ben White Blvd. The building's 29,000 square feet feature a taproom with a picturesque brewhouse backdrop, an airy 5,000 square foot covered patio, and a private loft that intertwines with the brewery itself. The loft boasts its own bar and seating area with great views of the brewery and taproom below.

Our scratch kitchen and bakery craft house-made bar snacks, sandwiches, shared plates, and desserts, all with a focus on quality and sustainability. And with over 30 taps, we have plenty of world-class craft beer, as well as a rotating selection of wines, ciders, and cold-pressed coffee.



THE COVERED PATIO



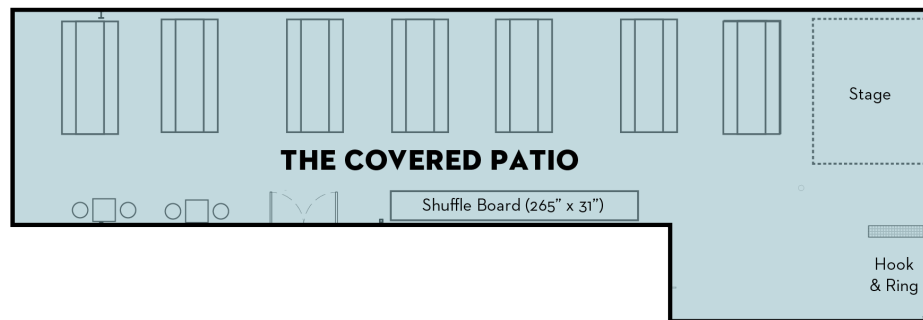

The Covered Patio space is nestled into the north side of Pinthouse Brewing, providing a nice area for private parties. This space features a shuffleboard table, hook and ring, the photogenic Texas mural, and a stage for entertainment.

VIBE Great for larger groups interested in having more laid-back events

CAPACITY Up to **120** people

AMENITIES

- Stage
- 6 beer garden tables
- Shuffleboard table
- Adirondack lounge
- Inquire about flexible seating options

SQ. FT **1,800**



THE BREWER'S LOFT



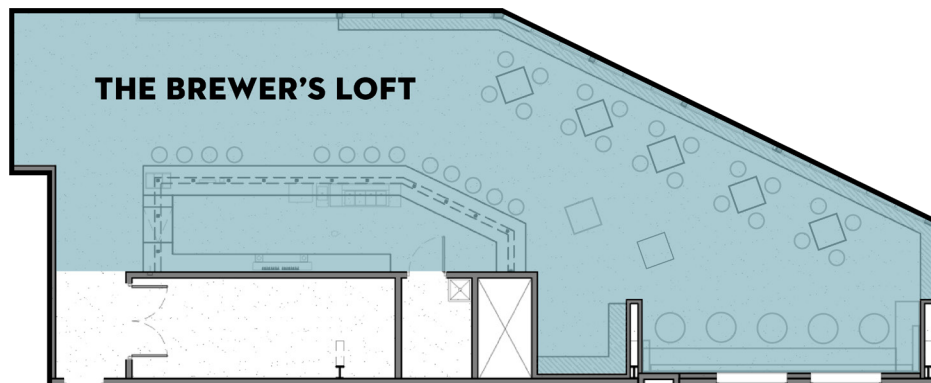

The Brewer's Loft provides a great event space for any occasion. With aerial views of the brewery and the tap room, it's a beautiful and truly unique setting. Enjoy the behind-the-scenes interworkings of an award-winning brewery. It's the perfect spot for a special gathering.

VIBE Private, more formal. Best for cocktail style events

CAPACITY Up to **90** people

AMENITIES

- Private bar overlooking taproom and brewing operations
- Private restroom
- Hightop and standard tables

SQ. FT **1,500**



ADD-ON PACKAGES

\$50 EACH

AUDIO/VISUAL PACKAGE

Our A/V Package offers access to a 65" TV, PA speakers, and wireless microphones. HDMI cord and USB-C adaptor available upon request.

PHOTO BOOTH BACKDROP

Our 7.5ft H x 6ft W Photo Booth Backdrop is available in white or black, and we have plenty of fun props available to choose from.

GAME PACKAGE

For a little added entertainment, our Game Package includes two mini cornhole sets, two table top ring toss games, and a bartop version of the classic arcade game, Centipede.



FAQ

Can we bring our own food?

While Pinthouse is the exclusive caterer for all of our onsite events, we are happy to allow you to bring in an outside cake to celebrate your special occasion.

Can we bring and serve off-site alcohol?

Pinthouse will be the sole provider of alcohol for your private event, but we promise we've got a little something for everyone!

Can we bring in outside tables, linens, and other rentals?

Of course! We want this event to look and feel just the way you envisioned it!

How long is the rental period?

While most private events range from 2-4 hours, we are happy to chat through custom timeframes for your event.

What is the booking process like?

Once we have a contract signed, 50% of the contracted total will be due.

Can you accommodate dietary restrictions?

Always! Let us know what you're working with and we will happily accommodate.

Can we bring in live music for our event?

Of course!

✦ REFERRAL BONUS ✦

REFER SOMEONE TO OUR EVENTS TEAM AND RECEIVE A \$100 PINTHOUSE GIFT CARD WHEN THEY BOOK AN EVENT WITH US!

Ask your Events Coordinator for more details.





CONTACT

To schedule your next event, or to speak with a member of our events team, please fill out the inquiry form at:

www.pighthouse.com/private-events

Or give us a call at:

(512) 222-8423

We look forward to hosting your next gathering!

Cheers,
The Pinhouse Team

